

THE NEW BARRIER
GREATER SPEED, ECONOMY, SAFETY

BARRIER

Guardrail system



The optimised BARRIER guardrail system from INNOTECH provides many varied application options in collective side protection, because it adapts optimally to individual construction conditions. The consistent optimisation of the individual components made it possible to improve the functionality and to significantly reduce the installation time. The uncomplicated, quick assembly and the option of

installing without roof perforation thus make the product a flexible all-rounder which perfectly blends in with the building's aesthetics in an extremely pleasing way. The high-quality railings are manufactured from weather-resistant aluminium, and fulfil the most demanding architectural requirements, through a varyingly adjustable inclination.

- Universal penetration-free application options
- Short installation time and simple assembly without creation of shavings
- Low superimposed load, thanks to maximum post separation of 2.2 m
- Pitch adjustable to 90° and 75°; hinged at 15°
- 100% plasticiser-free (integrated release layer)
- Attachment possible to standing seam and trapezoidal supporting sheet

- Concrete weight 2x 12.5 kg; stackable, ergonomic carrying system
- 3 standardised coating levels possible
- Differences in level up to 125mm can be compensated perfectly
- Inspection interval: 2 years
- Certification to the latest state of the art:

EN 13374:2019
EN ISO 14122-3:2016
DIN 14094-2:2017

System Vario

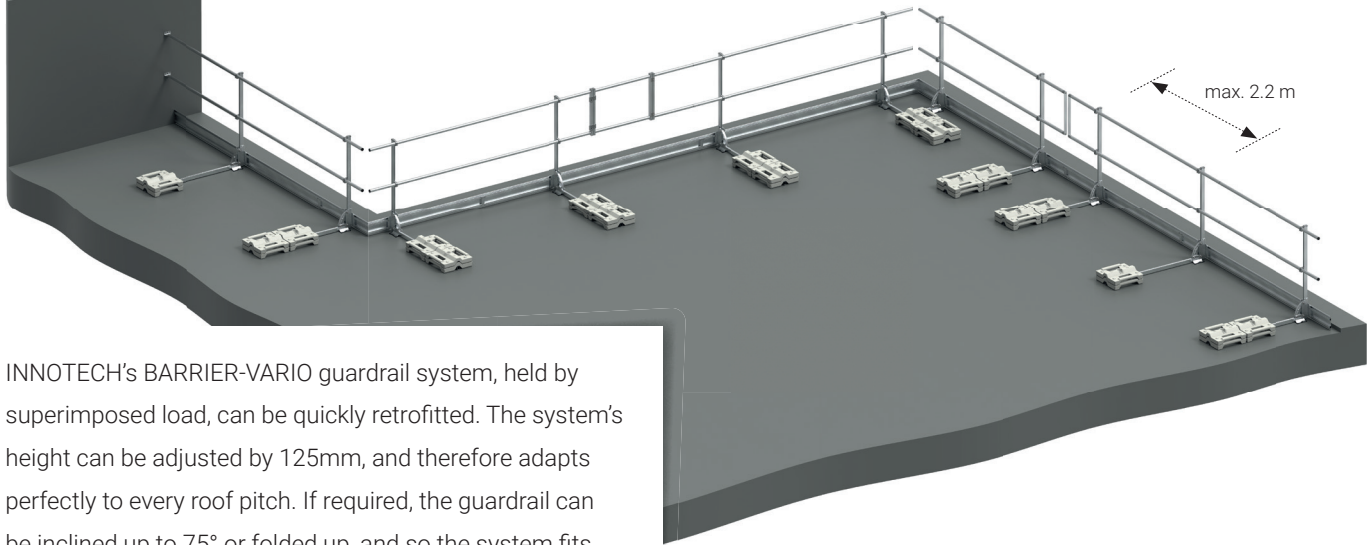

INNOTECH's BARRIER-VARIO guardrail system, held by superimposed load, can be quickly retrofitted. The system's height can be adjusted by 125mm, and therefore adapts perfectly to every roof pitch. If required, the guardrail can be inclined up to 75° or folded up, and so the system fits outstandingly well into the constructional circumstances.

SYSTEM VARIO

BARRIER VARIO

GUARDRAIL SYSTEM – HELD BY SUPERIMPOSED LOAD

Material: aluminium, stainless steel (AISI 304)

Substructure: Flat roof (max. 10° roof pitch)

System pitch angle (pre-assembled): 90°, 75°

Without roof perforation

Boom with post and concrete weight (2 x 12.5 kg) with carrying handles

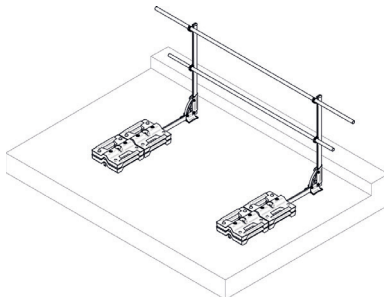

RATING PLATE

BARRIER-Z11

RATING PLATE FOR BARRIER

(EN 13374/EN ISO 14122-3/DIN 14094-2)

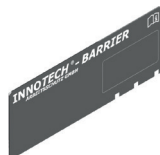

FOOT ELEMENT

BARRIER-V20

VARIO WEIGHT

Height x Width x Length: 93 x 390 x 390 mm

Weight: 12.5 kg

Material: Concrete

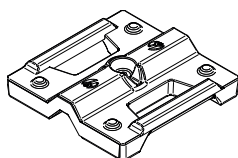

Concrete weight for BARRIER-V12 foot unit

FOOT ELEMENT

BARRIER-S22-450

VARIO BOOM

Length: 450 mm

Material: aluminium

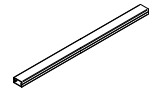

Standard boom for VARIO system, corner set

Special lengths upon request

BARRIER-S22-1300

VARIO BOOM

Length: 1300 mm

Material: aluminium

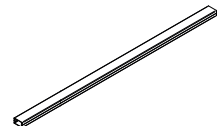

Standard boom for VARIO system, Escape route as per plan

Special lengths upon request

BARRIER-S22-1500

VARIO BOOM

Length: 1500 mm

Material: aluminium

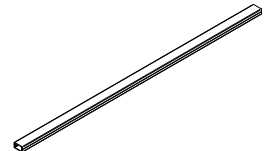

Standard boom for VARIO superimposed load.

Special lengths upon request

BARRIER-V12

VARIO-FOOT UNIT

Material: Aluminium, stainless steel (AISI 304), plastic

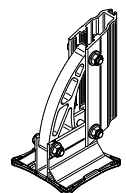

VARIO foot unit without boom/post, for creation of a collective side protection held by superimposed load, including protective plate

BARRIER-V92

VARIO-CORNER TIE

Material: stainless steel (AISI 304)

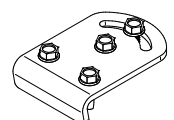

For the connection of two BARRIER-S22 booms

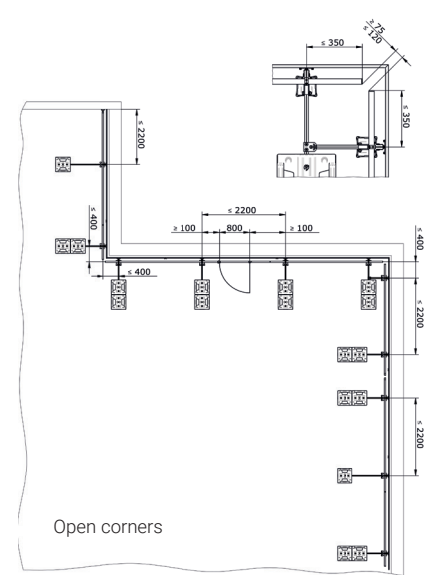
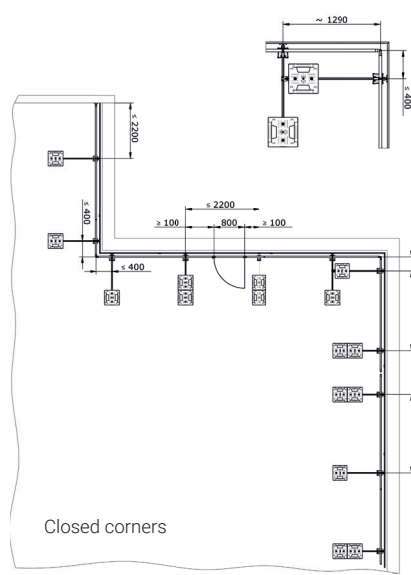
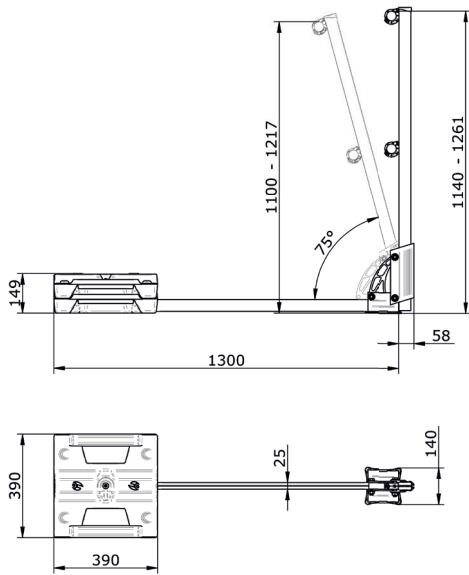

TOE BOARD

BARRIER-F20

TOE BOARD

Height x Width x Length: 170 x 20 x 3000 mm
 Material: aluminium

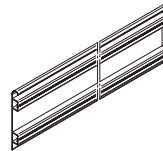

Suitable for use with BARRIER-S20/S21 post and VARIO BARRIER-V12 foot unit, when no parapet higher than 150mm present.

BARRIER-F22

TOE BOARD BRACKET FOR FASTENING THE TOE BOARD TO THE VARIO BARRIER-V12 FOOT UNIT

Material: aluminium, stainless steel (AISI 304)

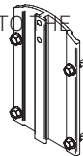

for fastening the BARRIER-F20 toe board to the VARIO BARRIER-V12 foot unit

BARRIER-F23

TOE BOARD CONNECTOR SET

Material: aluminium, stainless steel (AISI 304)

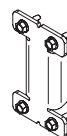

for connecting two BARRIER-F20 toe boards

POST

BARRIER-S20-1140

POST, VARIO SYSTEM, STRAIGHT

Length: 1080 mm
 Material: Aluminium/zinc, stainless steel



Standard post for VARIO system including pipe bracket.

DOOR

BARRIER-T30

DOOR SET

Material: aluminium

Opening 800 mm, fixed attachment point, not selectable (right hand door)

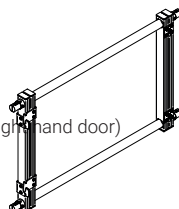

When used with superimposed load, 4x BARRIER-V20 weights required on each side

HANDRAIL

BARRIER-R11

ALUMINIUM PIPE, STRAIGHT

Diameter x Wall thickness x Length: 36 x 2.5 x 3000 mm
 Material: aluminium

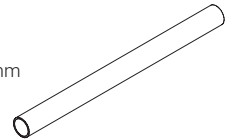

BARRIER-R21

LINEAR TIE

Material: aluminium, stainless steel (AISI 304)

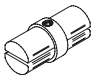

For connection of two BARRIER-R11 pipes

BARRIER-R31

CORNER TIE

Material: Aluminium, plastic

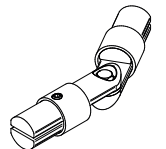

For creating a corner with two BARRIER-R11 pipes
 Variably adjustable angle

BARRIER-R41

WALL TIE

Substructure: Concrete, steel construction
 Material: Aluminium, plastic

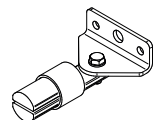

Variably adjustable angle

BARRIER-R51

END SEAL

Material: aluminium

End seal for two BARRIER-R11 pipes
 Projection of pipe max. 500 mm

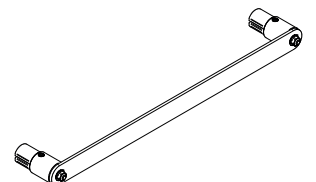

BARRIER-R91

CAP FOR BARRIER-R11 ALUMINIUM PIPE

Diameter x thickness: 36 x 2 mm
 Packaging unit: 2 items
 Material: Plastic



Cap for BARRIER-R11 pipes
 Projection of pipe max. 350 mm

System parapet

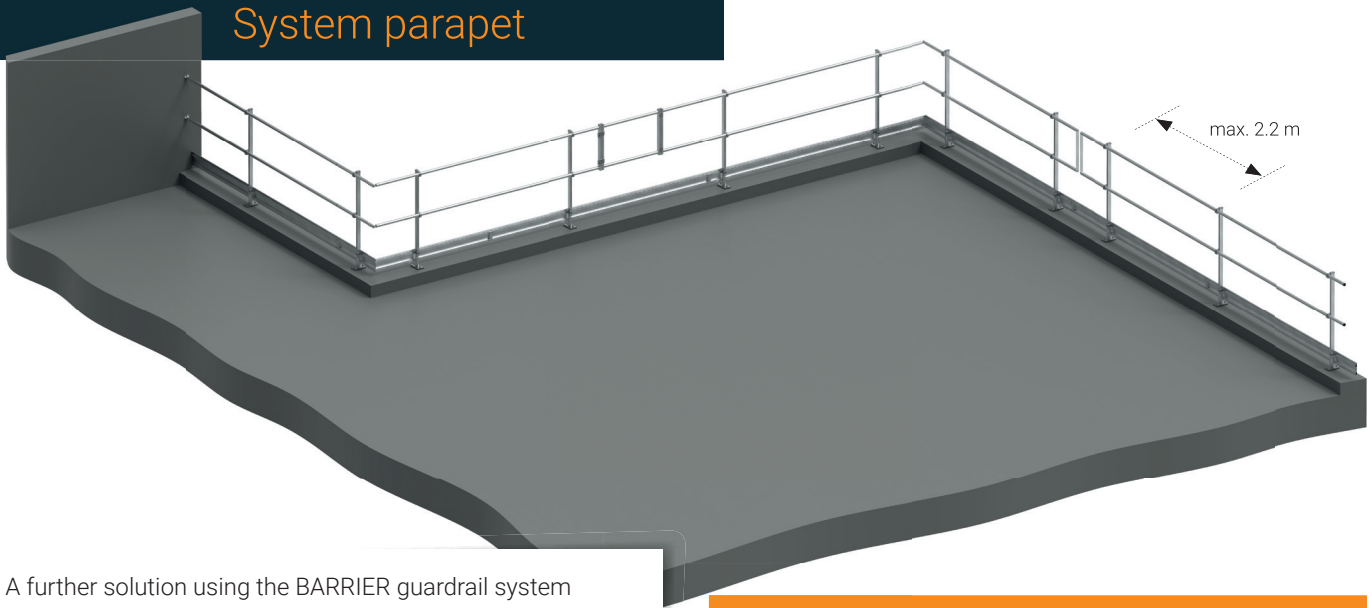

A further solution using the BARRIER guardrail system from INNOTECH is to install it on the parapet substructure. The guardrail system can be attached either on the parapet or alternatively to the inside of the parapet. The system's pitch angle is easily adjustable (90°, 75°, 60°). In order to maintain the building's aesthetics, it is possible to completely fold up the system.

SYSTEM VARIANTS

BARRIER-ATTIKA-OBEN (BARRIER PARAPET ON THE TOP)

GUARDRAIL SYSTEM - TOP OF PARAPET

Substructure: Parapet (top)
Material: aluminium, stainless steel (AISI 304)
System pitch angle: 90°

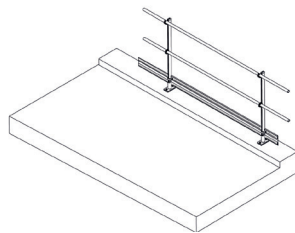

BARRIER-PARAPET ON THE SIDE

GUARDRAIL SYSTEM - INSIDE OR OUTSIDE OF PARAPET

Substructure: Parapet (inside or outside)
Material: aluminium, stainless steel (AISI 304)
System pitch angle: 90°, 75°, 60° for BARRIER-S22

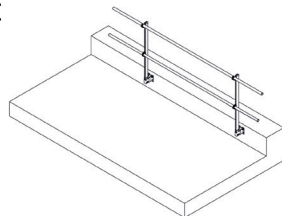

BARRIER-ATTIKA-SEITLICH (BARRIER PARAPET ON THE SIDE, HINGED)

GUARDRAIL SYSTEM - INSIDE OF PARAPET (HINGED)

Substructure: Parapet (inside)
Material: aluminium, stainless steel (AISI 304)
System pitch angle: 0°, 90° for BARRIER-S22

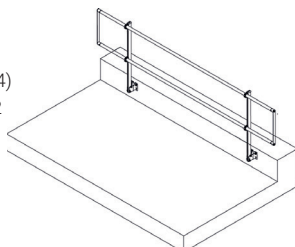

RATING PLATE

BARRIER-Z11

RATING PLATE FOR BARRIER
(EN 13374/EN ISO 14122-3/DIN 14094-2)



FOOT ELEMENT

BARRIER-A22

ADAPTER FOR ATTACHMENT TO THE TOP OF THE PARAPET

Substructure: Concrete, steel construction
Effective foot height: 137 mm
Material: aluminium, stainless steel (AISI 304)

For attachment of the BARRIER-S21 post to the top of the parapet

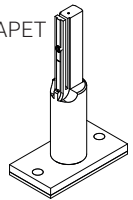

BARRIER-A10

ADAPTER ON THE SIDE OF THE PARAPET

Substructure: Concrete,
Pitch angle of steel construction: 90°, 75°, 60°
Material: aluminium, stainless steel (AISI 304)

For attachment of the BARRIER-S21 post to the inside of the parapet

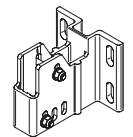

BARRIER-A11

ADAPTER ON THE INSIDE OF THE PARAPET (HINGED)

Substructure: Concrete,
Pitch angle of steel construction: 90°, 75°, 60°
Material: aluminium, stainless steel (AISI 304)

For attachment of the BARRIER-S21 post to the inside of a parapet

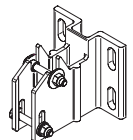

BARRIER-A31

SPACER BRACKET FOR PARAPET

Substructure: Concrete, steel construction
Material: aluminium, stainless steel (AISI 304)

2 different adjustment ranges (65 mm to 105 mm, or 100 mm to 145 mm for BARRIER-A10 and BARRIER-A11)

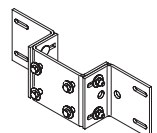

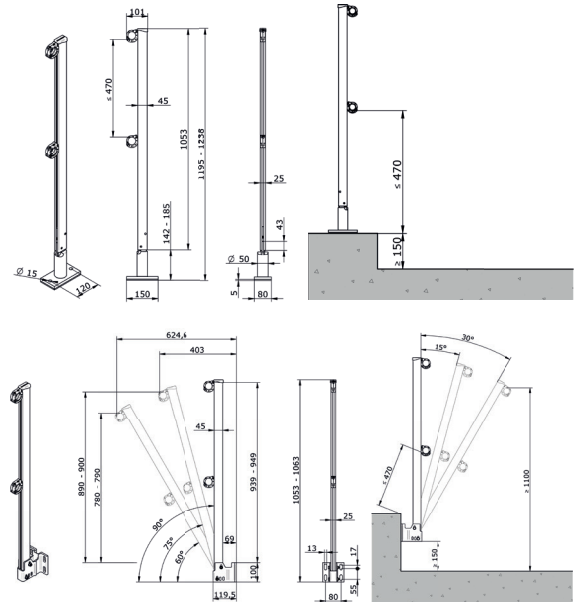
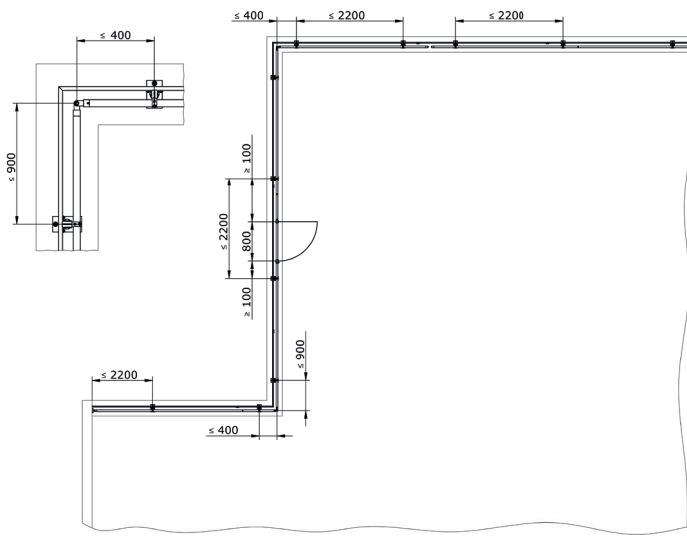

TOE BOARD

BARRIER-F20

TOE BOARD

Height x Width x Length: 170 x 20 x 3000 mm
 Material: aluminium

Suitable for use with BARRIER-S20/S21 post and VARIO BARRIER-V12 foot unit, when no parapet higher than 150mm present.

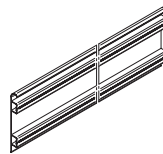

BARRIER-F21

TOE BOARD BRACKET FOR FASTENING THE TOE BOARD TO THE BARRIER-S10 POST

Height x Width: 25 x 45 mm
 Packaging unit: 2 items
 Material: aluminium, stainless steel (AISI 304)

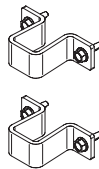

For attachment of the BARRIER-F20 toe board to the BARRIER-S21 post

BARRIER-F23

TOE BOARD CONNECTOR SET

Material: aluminium, stainless steel (AISI 304)

for connecting two BARRIER-F20 toe boards



POST

BARRIER-S21-1050

POST, STRAIGHT

Length: 1050 mm
 Material: Aluminium, aluminium/zinc, stainless steel

Standard post for ATTIKA system including pipe bracket.

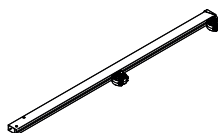

DOOR

BARRIER-T30

DOOR SET

Material: aluminium

Opening 800 mm, fixed attachment point, not selectable (right hand door)

For implementation using superimposed load, 4x BARRIER-V20 weights required for each door side.

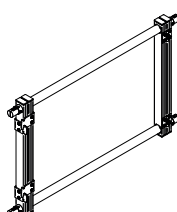

HANDRAIL

BARRIER-R11

ALUMINIUM PIPE, STRAIGHT

Diameter x Wall thickness x Length: 36 x 2.5 x 3000 mm
 Material: aluminium

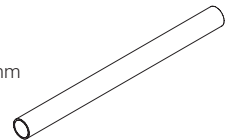

BARRIER-R21

LINEAR TIE

Material: aluminium, stainless steel (AISI 304)

For connection of two BARRIER-R11 pipes

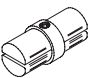

BARRIER-R31

CORNER TIE

Material: Aluminium, plastic

For creating a corner with two BARRIER-R11 pipes, variably adjustable angle

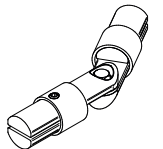

BARRIER-R41

WALL TIE

Substructure: Concrete, steel construction
 Material: Aluminium, plastic

Variably adjustable angle

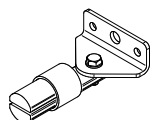

BARRIER-R51

END SEAL

Material: aluminium

End seal for two BARRIER-R11 pipes
 Projection of pipe max. 500 mm

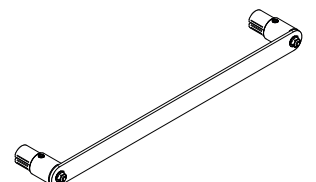

BARRIER-R91

CAP FOR BARRIER-R11 ALUMINIUM PIPE

Diameter x thickness: 36 x 2 mm
 Packaging unit: 2 items
 Material: Plastic

Cap for BARRIER-R11 pipes
 Projection of pipe max. 350 mm



Skylight system

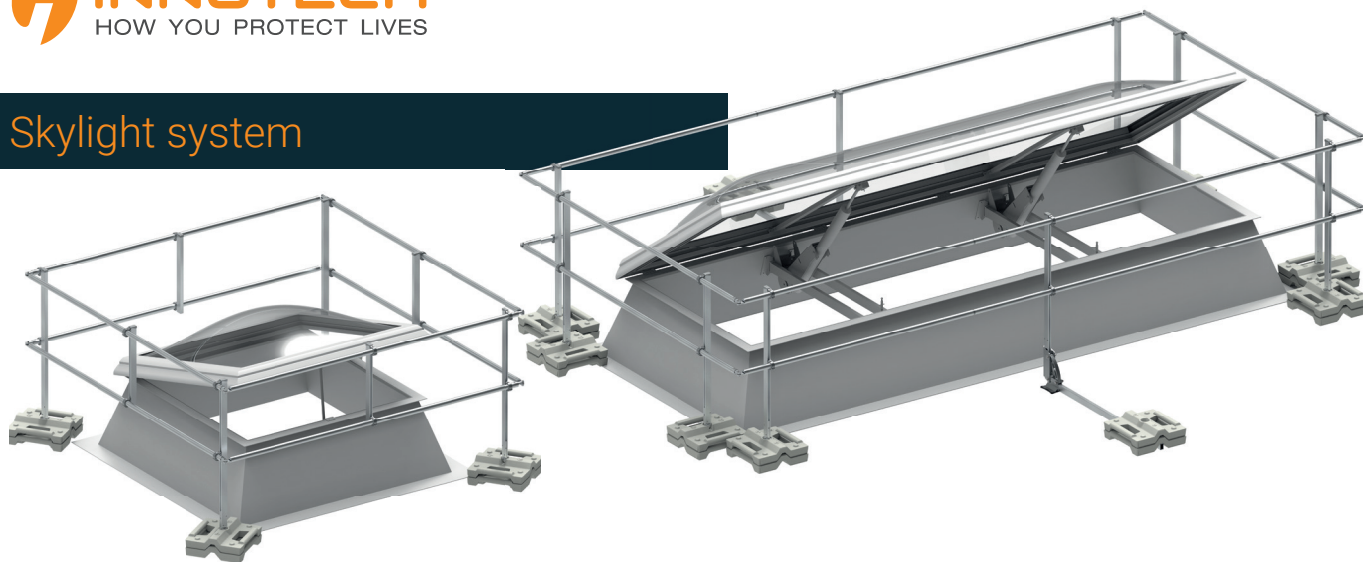

The skylight guard from INNTECH is the ideal protection for skylights and roof lights. Installation takes place without roof perforation and provides optimum protection.

SYSTEM VARIANTS

BARRIER VARIO

GUARDRAIL SYSTEM – HELD BY SUPERIMPOSED LOAD

Material: aluminium, stainless steel (AISI 304)

Substructure: Flat roof

(max. 10° roof pitch)

System pitch angle

(pre-assembled): 90°, 75°

Without roof penetration

Boom with post and concrete weight (2 x 12.5 kg) with carrying handles

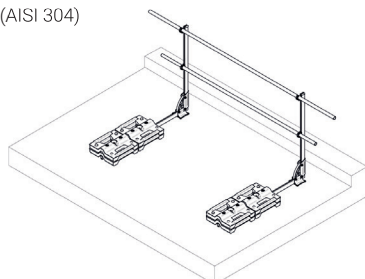

RATING PLATE

BARRIER-Z11

RATING PLATE FOR BARRIER

(EN 13374/EN ISO 14122-3/DIN 14094-2)

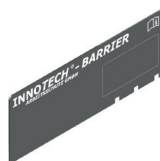

FOOT ELEMENT

BARRIER-V20

VARIO WEIGHT

Height x Width x Length: 93 x 390 x 390 mm

Weight: 12.5 kg

Material: Concrete

Concrete weight for BARRIER-V12 foot unit

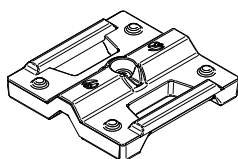

FOOT ELEMENT

BARRIER-S22-1300

VARIO BOOM

Length: 1300 mm

Material: aluminium

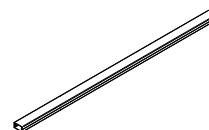

Standard boom for VARIO system, escape route as per plans
Special lengths upon request

BARRIER-V12

VARIO-FOOT UNIT

Material: Aluminium, stainless steel (AISI 304), plastic

VARIO foot unit without boom/post, for creation of a collective side protection held by superimposed load, including protective plate

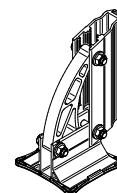

BARRIER-V82

VARIO ADAPTER FOOT

Application: Creation of a skylight guard of max. 2000 x 2000 mm

Material: Aluminium, stainless steel (AISI 304) for attaching the BARRIER-S21 post to a BARRIER-V20 VARIO weight



POST

BARRIER-S20-1140

POST, VARIO SYSTEM, STRAIGHT

Length: 1080 mm

Material: Aluminium/zinc, stainless steel



Standard post for VARIO system including pipe bracket.

DOOR

BARRIER-T30

DOOR SET

Material: aluminium

Opening 800 mm, fixed attachment point, not selectable (right hand door)

For implementation using superimposed load, 4x BARRIER-V20 weights required for each door side.

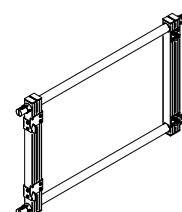

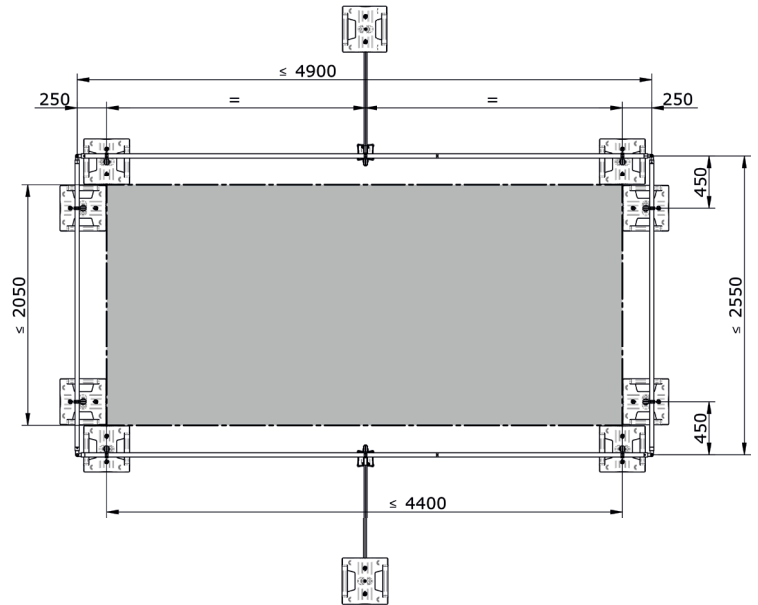
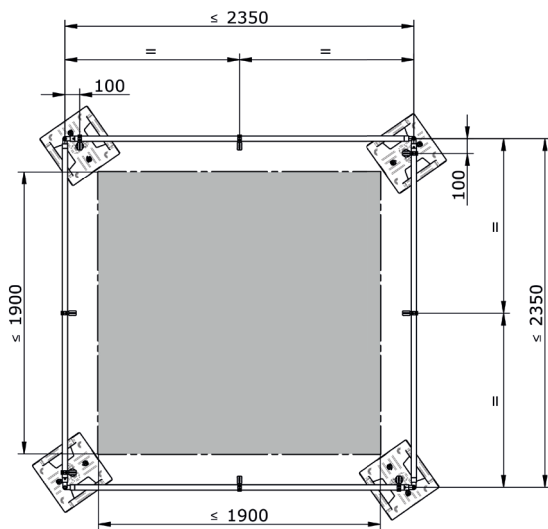

HANDRAIL

BARRIER-R11

ALUMINIUM PIPE, STRAIGHT

Diameter x Wall thickness x Length: 36 x 2.5 x 3000 mm

Material: aluminium

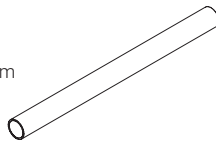

BARRIER-R21

LINEAR TIE

Material: aluminium, stainless steel (AISI 304)



For connection of two BARRIER-R11 pipes

BARRIER-R31

CORNER TIE

Material: Aluminium, plastic

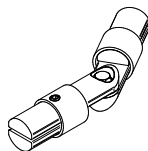

For creating a corner with two BARRIER-R11 pipes
Variably adjustable angle

BARRIER-S23

SIDE BAR

Length x Width x Height: 565 x 45 x 25 mm

Material: Aluminium, aluminium/zinc,
stainless steel

Stiffening strut for BARRIER-R11 pipe

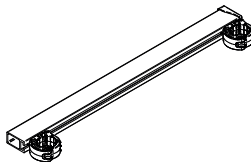

UNIVERSAL APPLICATION
POSSIBILITIES

SHAVINGS-FREE INSTALLATION
DISCREET FLUSH-MOUNTED DE-
SIGN

BARRIER / guardrail system

SYSTEM VARIO escape route

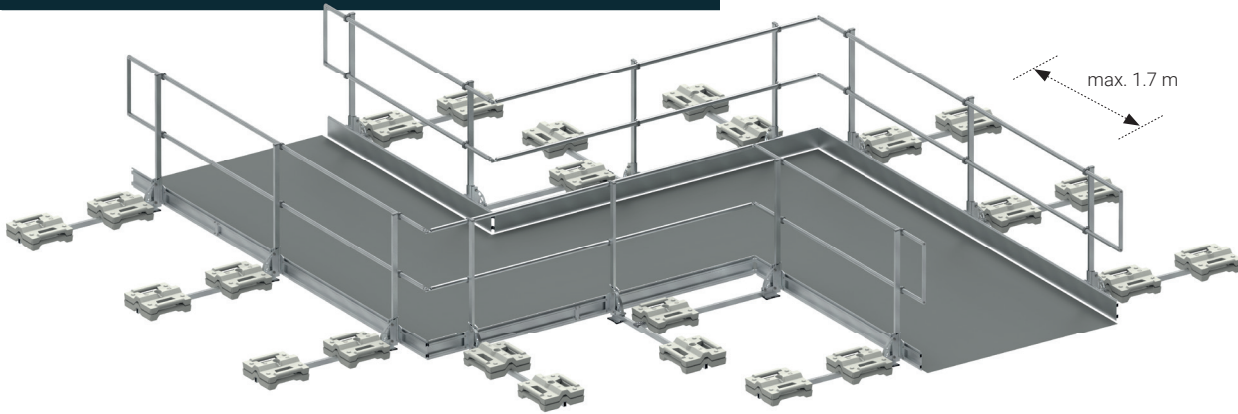

The SYSTEM-VARIO escape route from INNOTECH is held by self supporting load and therefore installed without roof perforation. The width of the flexible system is adjustable, requires significantly less material because of the greater separation distances, and therefore reduces the superimposed load.

RATING PLATE

BARRIER-Z11

RATING PLATE FOR BARRIER
(EN 13374/EN ISO 14122-3/DIN 14094-2)

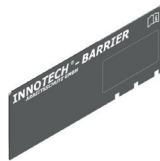

FOOT ELEMENT

BARRIER-V20

VARIO WEIGHT

Height x Width x Length: 93 x 390 x 390 mm
Weight: 12.5 kg
Material: Concrete

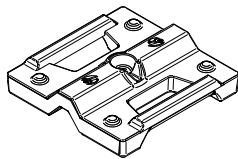

Concrete weight for BARRIER-V12 foot unit

BARRIER-S22-1300

VARIO BOOM

Length: 1300 mm
Material: aluminium

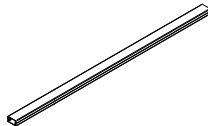

Standard boom for VARIO system,
escape route as per plans

Special lengths upon request

BARRIER-V12

VARIO-FOOT UNIT

Material: Aluminium, stainless steel (AISI 304), plastic

VARIO foot unit without boom/post, for creation of a collective side protection held by superimposed load, including protective plate

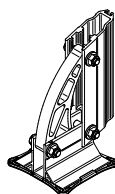

FOOT ELEMENT

BARRIER-V92

VARIO-CORNER TIE

Material: stainless steel (AISI 304)

For the connection of two BARRIER-S22 booms

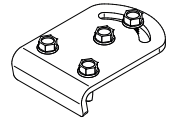

TOE BOARD

BARRIER-F20

TOE BOARD

Height x Width x Length: 170 x 20 x 3000 mm
Material: aluminium

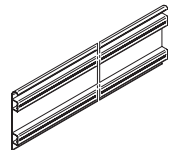

Suitable for use with BARRIER-S20/S21 post and
VARIO BARRIER-V12 foot unit,
when no parapet higher than 150mm is present.

BARRIER-F22

TOE BOARD BRACKET FOR FASTENING
THE TOE BOARD TO THE VARIO BARRIER-V12 FOOT UNIT
Material: aluminium, stainless steel (AISI 304)

for fastening the BARRIER-F20 toe board
to the VARIO BARRIER-V12 foot unit

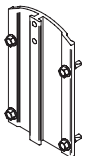

BARRIER-F23

TOE BOARD CONNECTOR SET

Material: aluminium, stainless steel (AISI 304)

for connecting two BARRIER-F20 toe boards

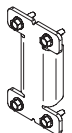

POST

BARRIER-S20-1140

POST, VARIO SYSTEM, STRAIGHT

Length: 1080 mm
Material: Aluminium/zinc, stainless steel

Standard post for VARIO system including pipe bracket.

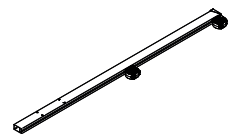

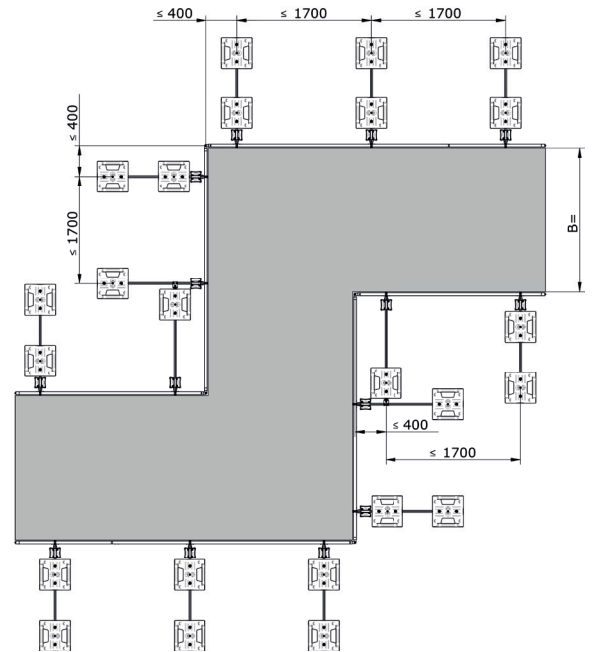
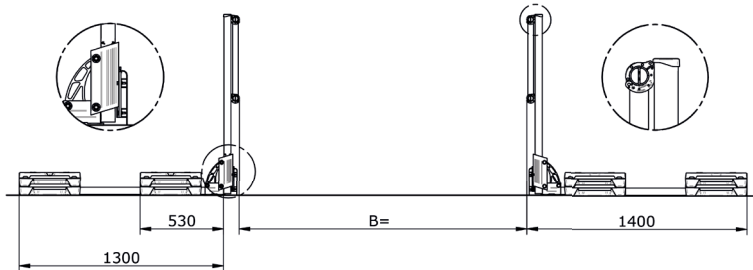

HANDRAIL

BARRIER-R11

ALUMINIUM PIPE, STRAIGHT

Diameter x Wall thickness x Length: 36 x 2.5 x 3000 mm

Material: aluminium

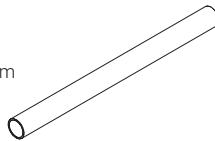

BARRIER-R21

LINEAR TIE

Material: aluminium, stainless steel (AISI 304)

For connection of two BARRIER-R11 pipes



BARRIER-R31

CORNER TIE

Material: Aluminium, plastic

For creating a corner with two BARRIER-R11 pipes
 Variably adjustable angle

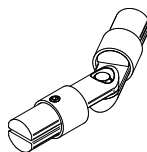

BARRIER-R41

WALL TIE

Substructure: Concrete, steel construction

Material: Aluminium, plastic

Variably adjustable angle

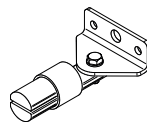

HANDRAIL

BARRIER-R51

END SEAL

Material: aluminium

End seal for two BARRIER-R11 pipes
 Projection of pipe max. 500 mm

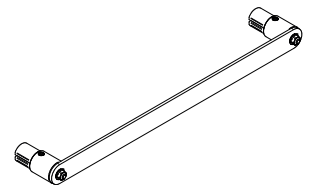

BARRIER-R91

CAP FOR BARRIER-R11 ALUMINIUM PIPE

Diameter x thickness: 36 x 2 mm

Packaging unit: 2 items

Material: Plastic

Cap for BARRIER-R11 pipes
 Projection of pipe max. 350 mm



DOOR

BARRIER-T30

DOOR SET

Material: aluminium

Opening 800 mm, fixed attachment point,
 not selectable (right hand door)

For implementation using superimposed load,
 4x BARRIER-V20 weights required for each door side.

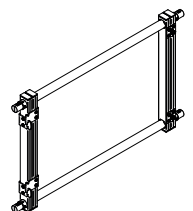

System concrete slabs for escape route



The escape route system from INNOTECH, using concrete slabs, is held in place by superimposed load, and installed without roof penetration. The width of the flexible system is adjustable, and is extremely space-saving thanks to the innovative design.

RATING PLATE

BARRIER-Z11

RATING PLATE FOR BARRIER
(EN 13374/EN ISO 14122-3/DIN 14094-2)

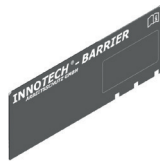

FOOT ELEMENT

BARRIER-S22-1300

VARIO BOOM
Length: 1300 mm
Material: aluminium

Standard boom for VARIO system,
escape route as per plans

Special lengths upon request

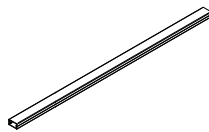

BARRIER-V12

VARIO-FOOT UNIT
Material: Aluminium, stainless steel (AISI 304), plastic

VARIO foot unit without boom/post, for creation of a collective
side protection held by superimposed load,
including protective plate

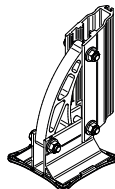

BARRIER-Z50-3000

FOOTWAY RAIL FOR EMERGENCY ESCAPE ROUTES
Height x Width x Length: 50 x 80 x 3000 mm
Application: Escape routes
Material: aluminium

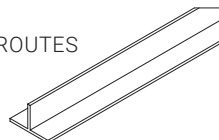

For the creation of escape routes using concrete slabs

TOE BOARD

BARRIER-F20

TOE BOARD

Height x Width x Length: 170 x 20 x 3000 mm
Material: aluminium

Suitable for use with BARRIER-S20/S21 post and
VARIO BARRIER-V12 foot unit, when no parapet higher
than 150mm is present.

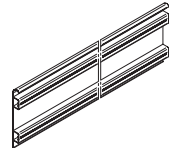

BARRIER-F22

TOE BOARD BRACKET FOR FASTENING THE TOE BOARD
TO THE VARIO BARRIER-V12 FOOT UNIT

Material: aluminium, stainless steel (AISI 304)

for fastening the BARRIER-F20 toe board
to the VARIO BARRIER-V12 foot unit

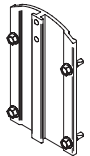

BARRIER-F23

TOE BOARD CONNECTOR SET

Material: aluminium, stainless steel (AISI 304)

for connecting two BARRIER-F20 toe boards

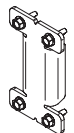

POST

BARRIER-S20-1140

POST, VARIO SYSTEM, STRAIGHT

Length: 1080 mm
Material: Aluminium/zinc, stainless steel

Standard post for VARIO system including pipe bracket.

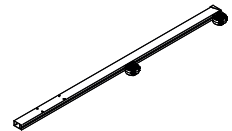

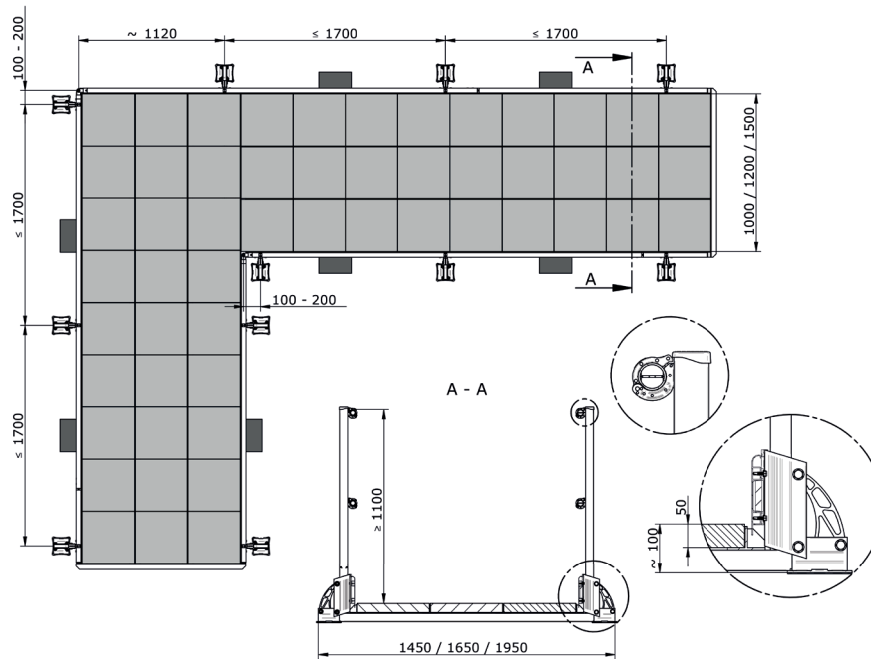

HANDRAIL

BARRIER-R11

ALUMINIUM PIPE, STRAIGHT

Diameter x Wall thickness x Length: 36 x 2.5 x 3000 mm

Material: aluminium

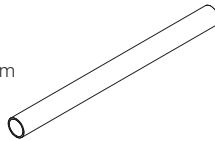

BARRIER-R21

LINEAR TIE

Material: aluminium, stainless steel (AISI 304)

For connection of two BARRIER-R11 pipes



BARRIER-R31

CORNER TIE

Material: Aluminium, plastic

For creating a corner with two BARRIER-R11 pipes, variably adjustable angle

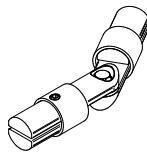

BARRIER-R41

WALL TIE

Substructure: Concrete, steel construction

Material: Aluminium, plastic

Variably adjustable angle

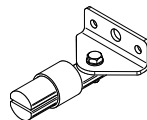

HANDRAIL

BARRIER-R51

END SEAL

Material: aluminium

End seal for two BARRIER-R11 pipes
Projection of pipe max. 500 mm

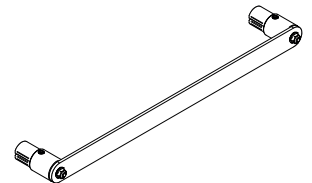

BARRIER-R91

CAP FOR BARRIER-R11 ALUMINIUM PIPE

Diameter x thickness: 36 x 2 mm

Packaging unit: 2 items

Material: Plastic

Cap for BARRIER-R11 pipes

Projection of pipe max. 350 mm



DOOR

BARRIER-T30

DOOR SET

Material: aluminium

Opening 800 mm, fixed attachment point, not selectable (right hand door)

When used with superimposed load, 4x BARRIER-V20 weights required on each side

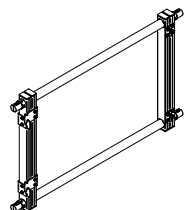

THE INNOTECH SAFETY TRAINING

INNO|training

Onsite in your company.

You think that our training courses are great,
but you can't send your employees to us?

NO PROBLEM - IN THAT CASE, WE'LL COME TO YOU!

INNO|training guarantees compact training onsite; this includes the same audiovisual presentations available in our INNO|school, provided by your personal technical representative. In the training bus, you can inspect our products up close and in detail, and the very comfortable seating makes the training a top class event which you should not miss!

After completion of the 4 to 5 hour INNO|training, you receive your own personal certificate, and are therefore trained to install our products correctly.

This INNO|training certificate is valid for 18 months.

During this period, you are able to attend the INNO|school training and here to complete the modules which are still open. As a graduate of the INNO|school, you receive a certificate which is not time-limited.

The benefits for you as an INNOTECH® customer:

- Training at first hand from your personal tutor.
- Huge time-saving
- Fully equipped training bus
- Comfortable seating for 6 persons
- Integrated electronics for high-tech presentations



Book your next training right now:

T: +43 7619 22122-181 | E: training@innotech.at
www.innotech.at

